

COMMUNE DE BOURG-EN-LAVAU  
AMENAGEMENT DE L'INTERFACE  
DE LA GARE DE CULLY  
/PLACE FRANÇOISE FONJALLAZ  
/CHEMIN DE COURSEBOUX



INFORMATION À LA POPULATION  
COMMUNE DE BOURG-EN-LAVAU / 26.02.2024

BONNARD  
+ WOEFFRAY

# CONTEXTE \_ CULLY



# CONTEXTE \_ CULLY



# EMPRISE DE PROJET

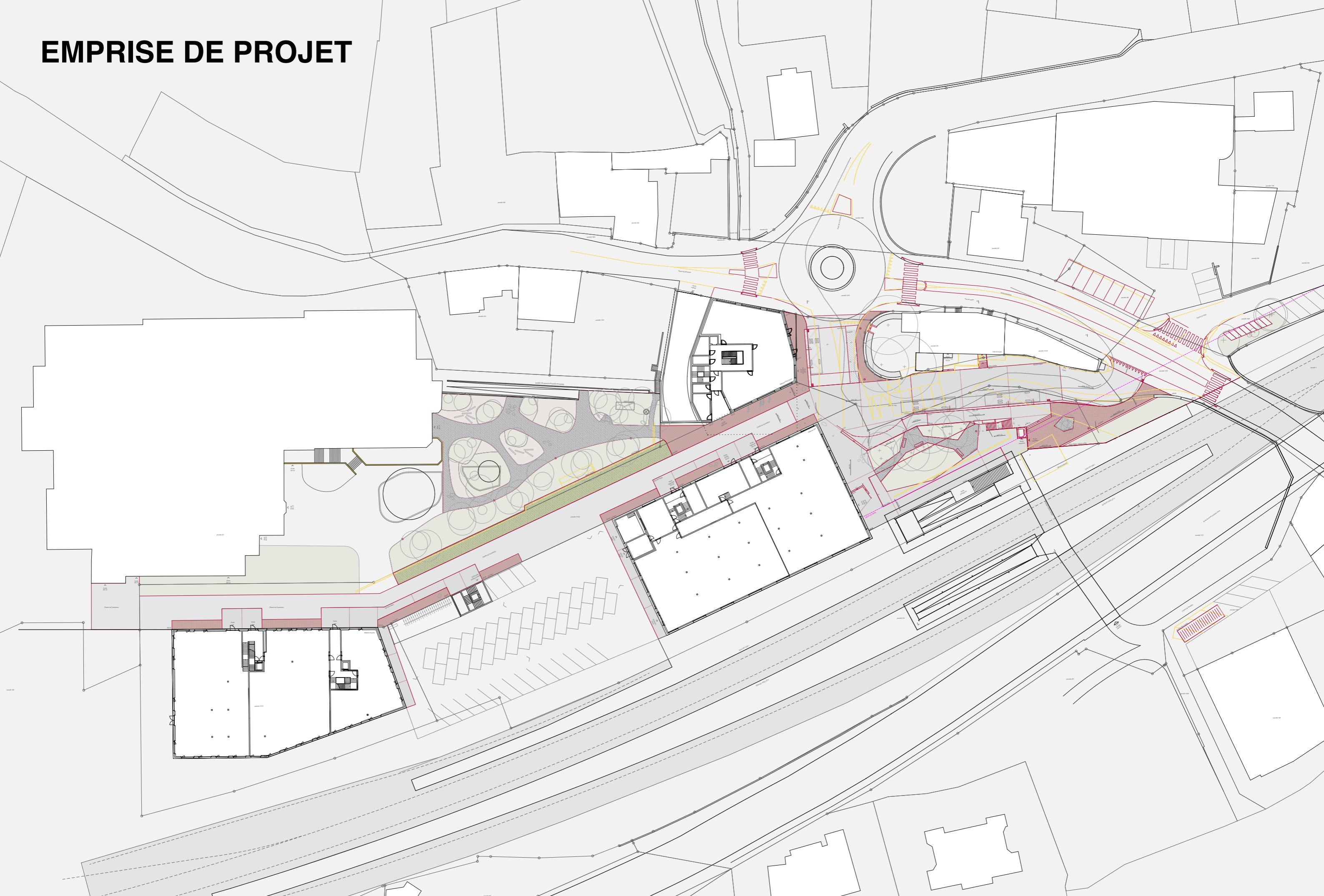

# CHEMIN DE COURSEBOUX

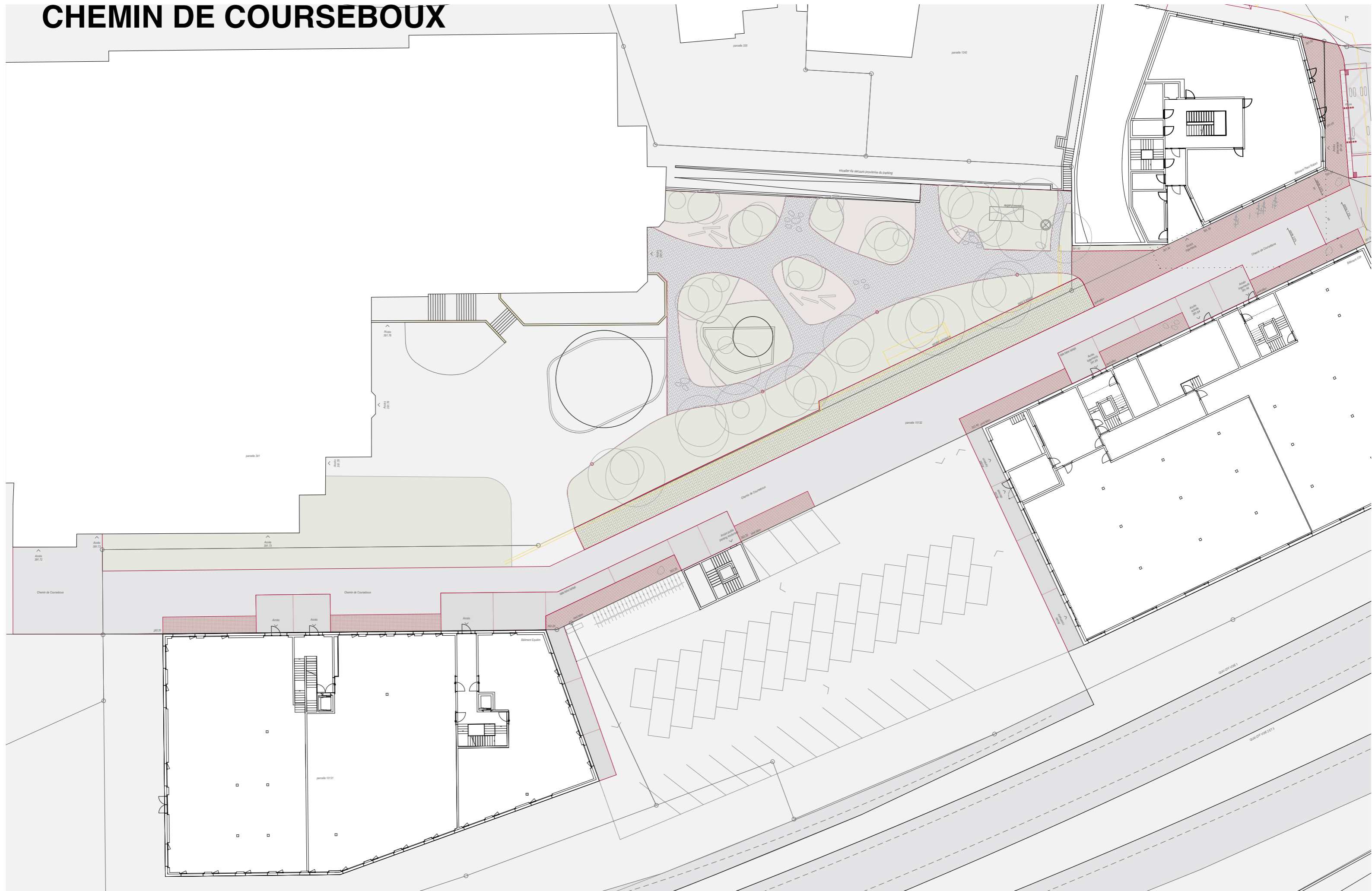

# PLACE FRANÇOISE FONJALLAZ \_ NIVEAU QUAI

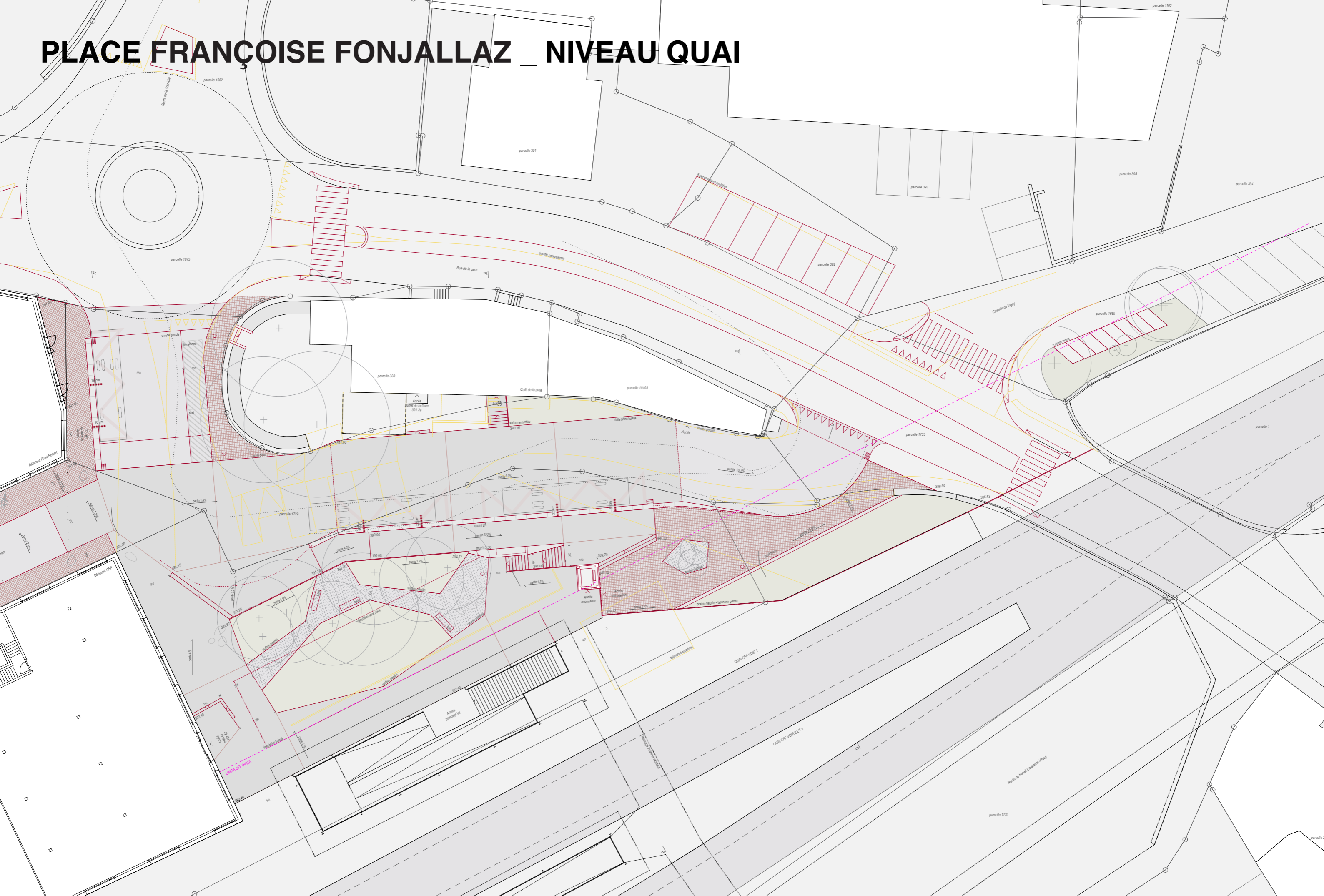

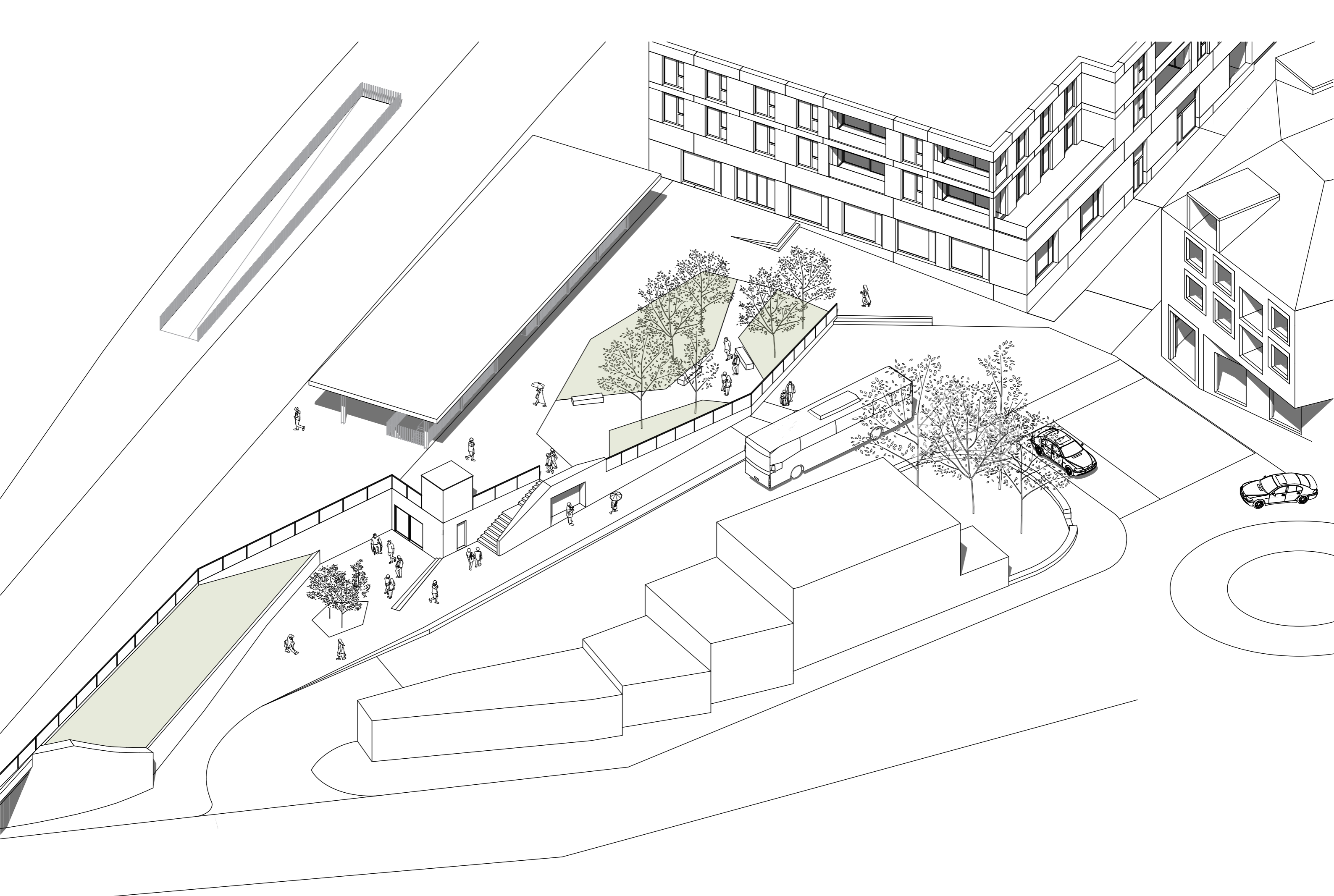

# PLACE FRANÇOISE FONJALLAZ \_ NIVEAU VÉLOSTATION

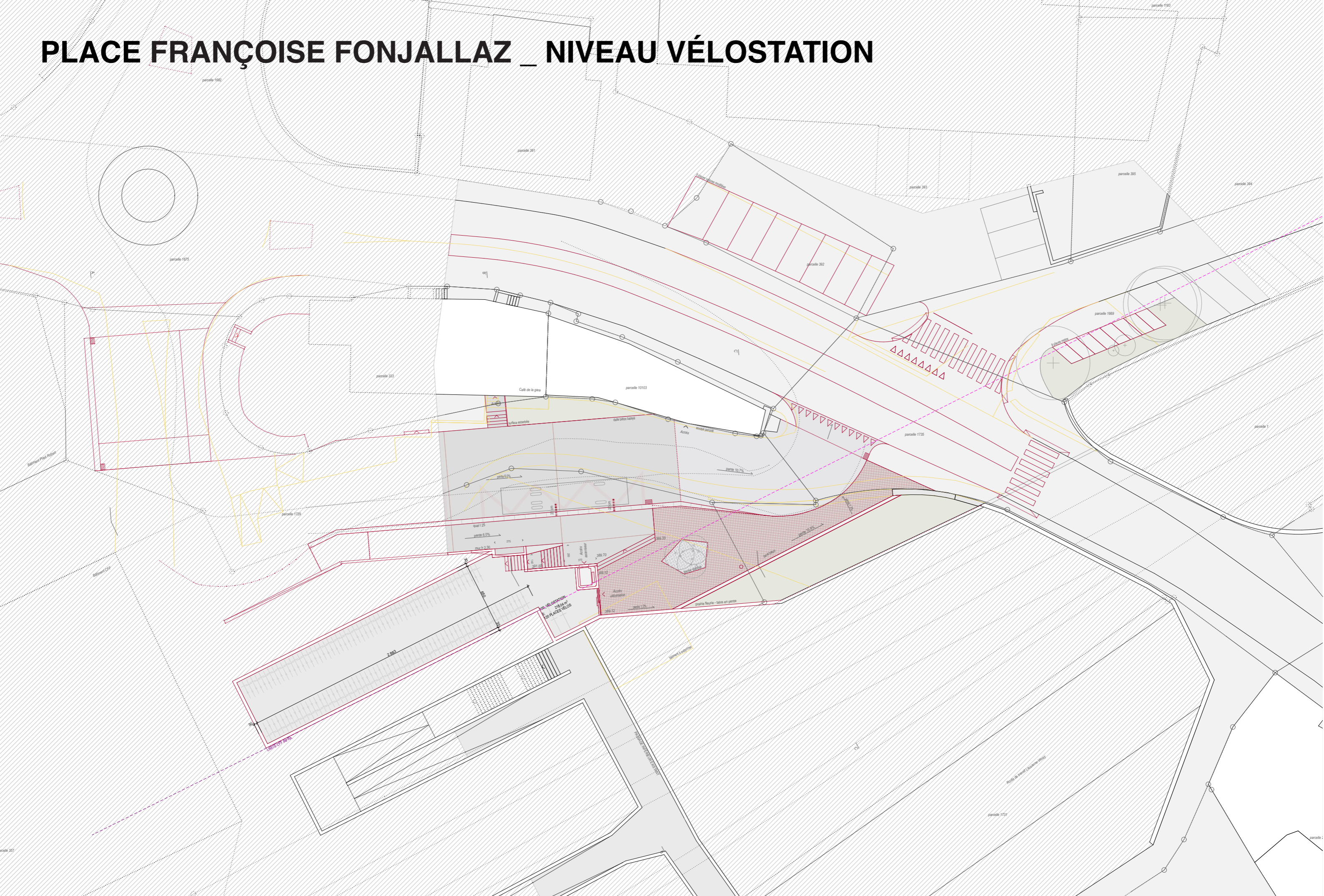



# FLUX DE CIRCULATION

## FLUX\_BUS

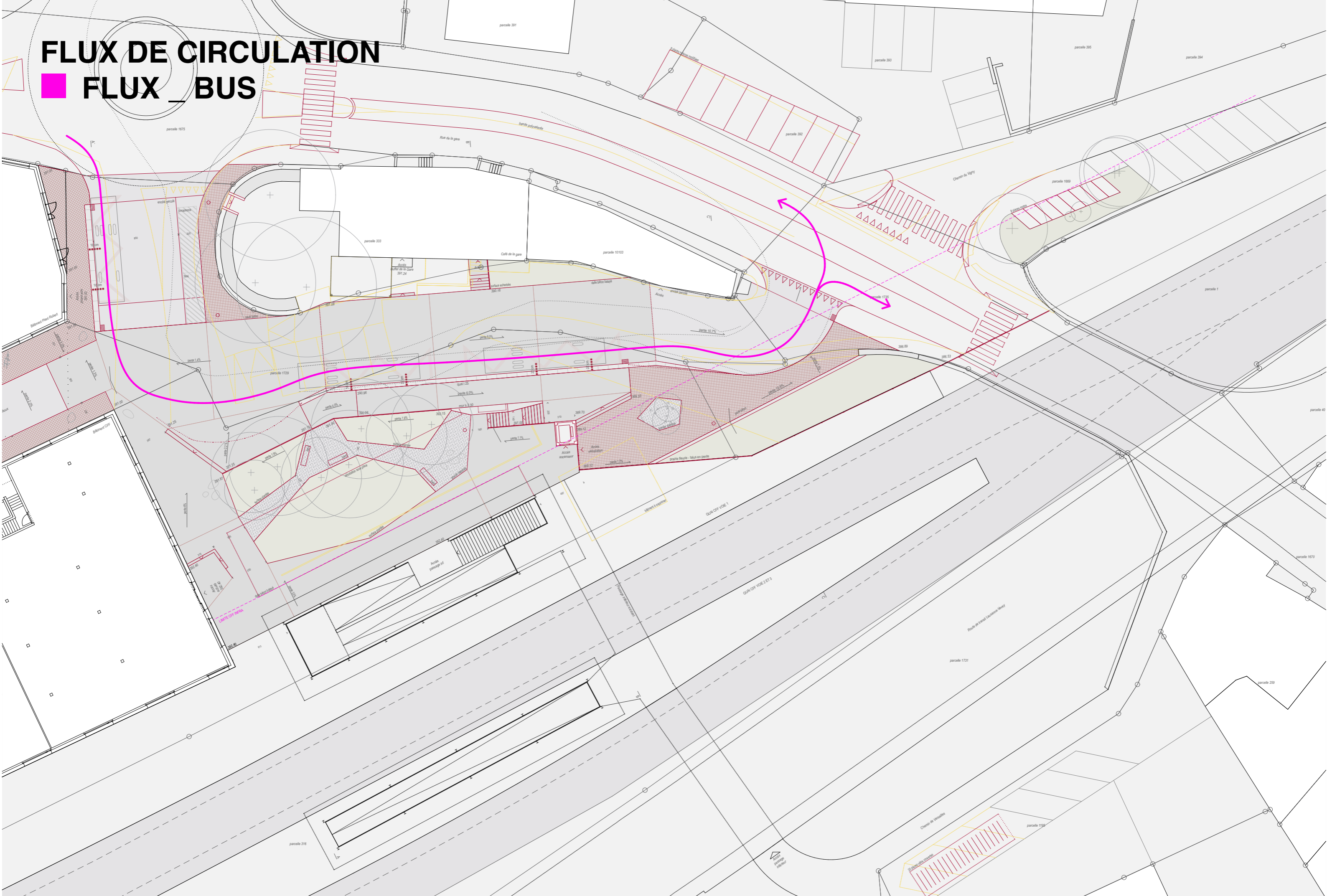

# FLUX DE CIRCULATION

■ FLUX\_VOITURE

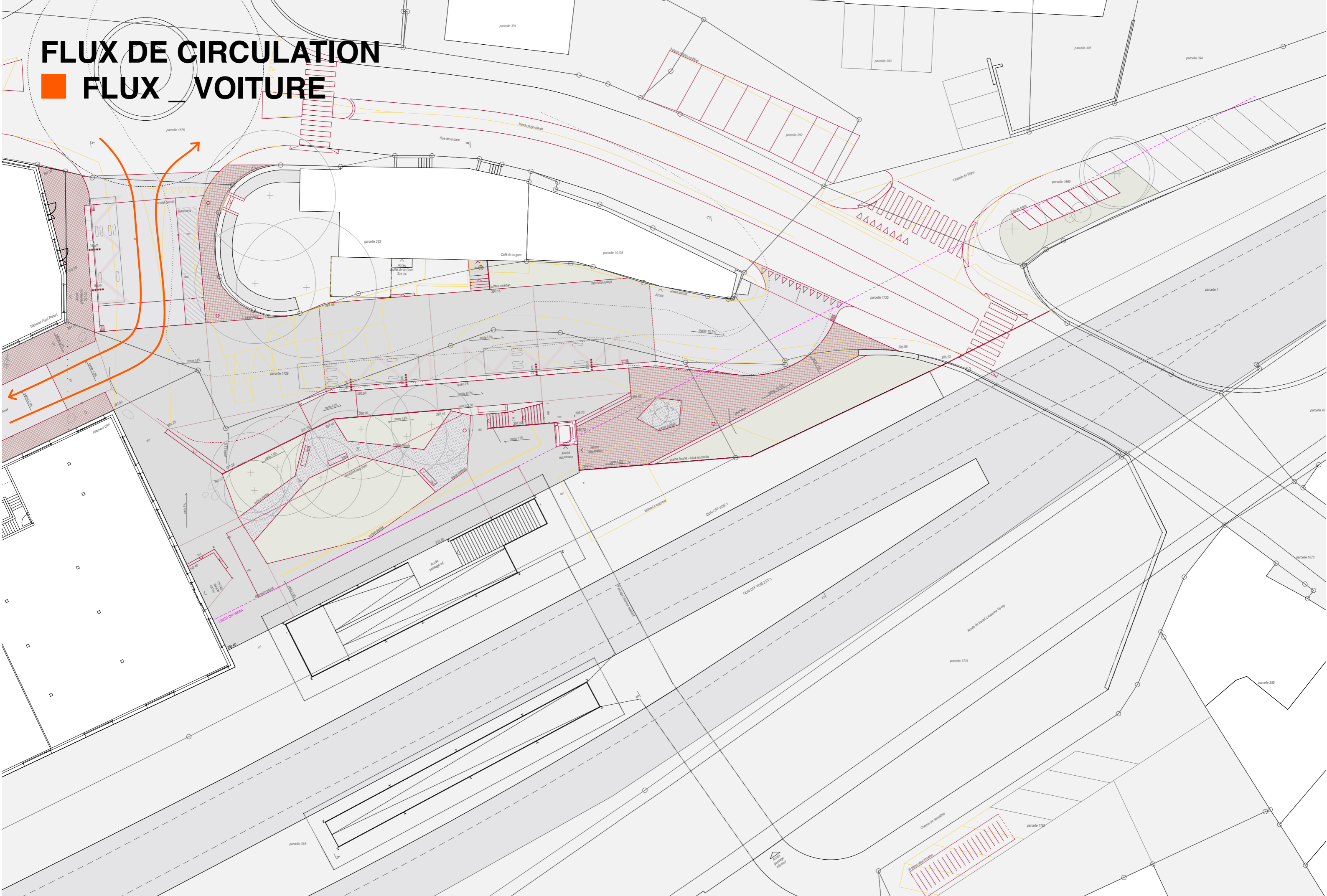

# FLUX DE CIRCULATION

■ FLUX\_VÉLO

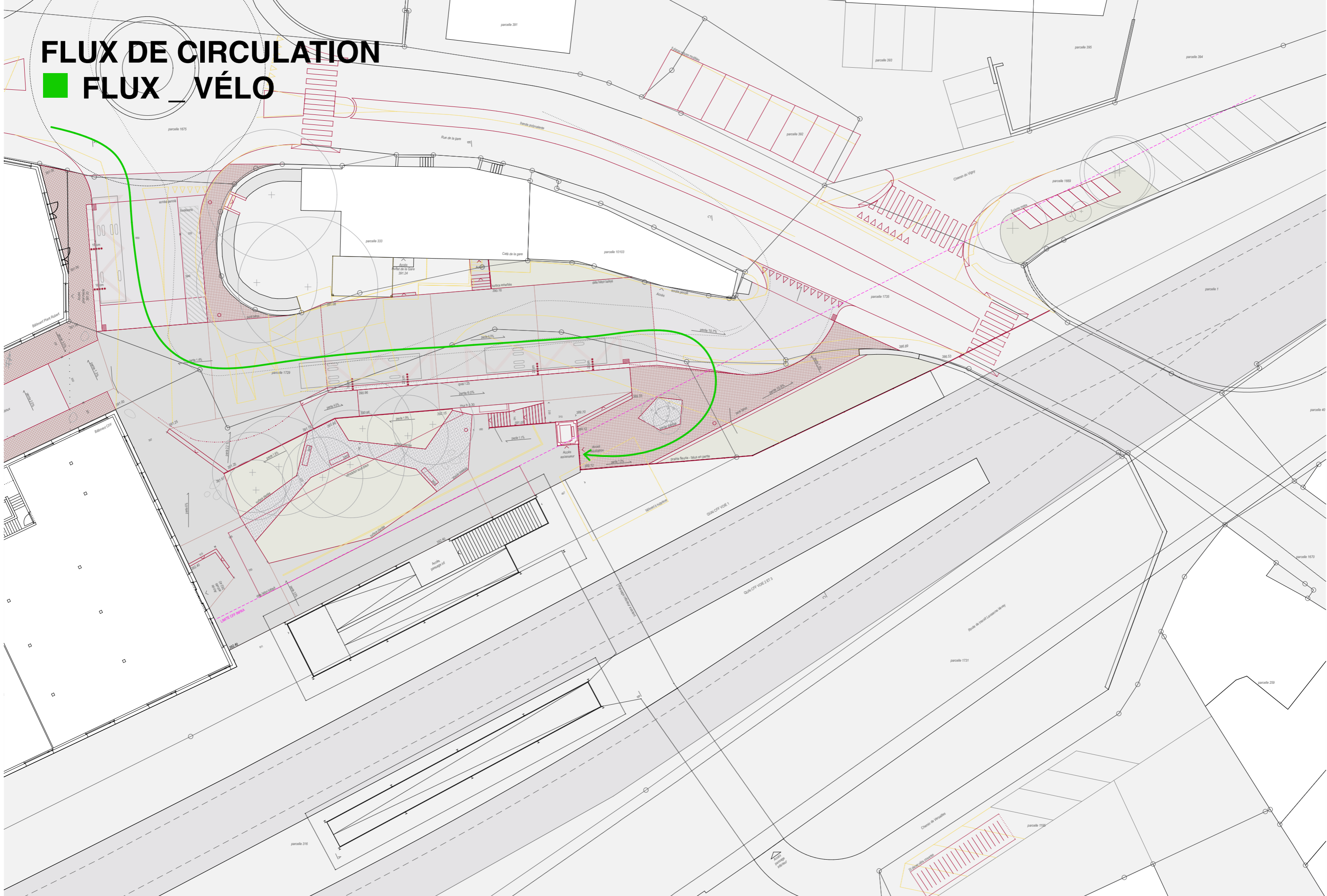





# FLUX DE CIRCULATION

## ■ FLUX LIVRAISON

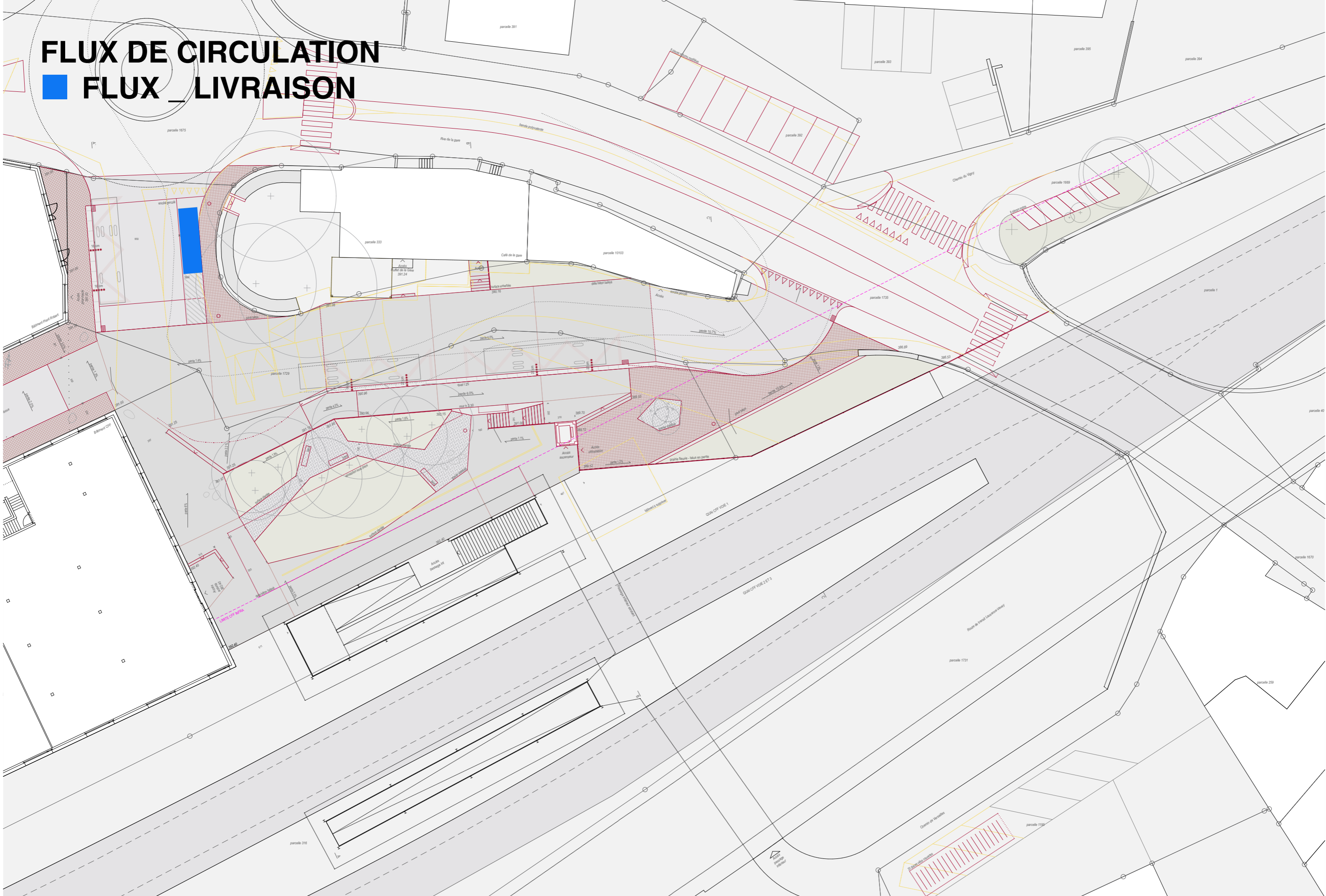

# MATERIALITÉ

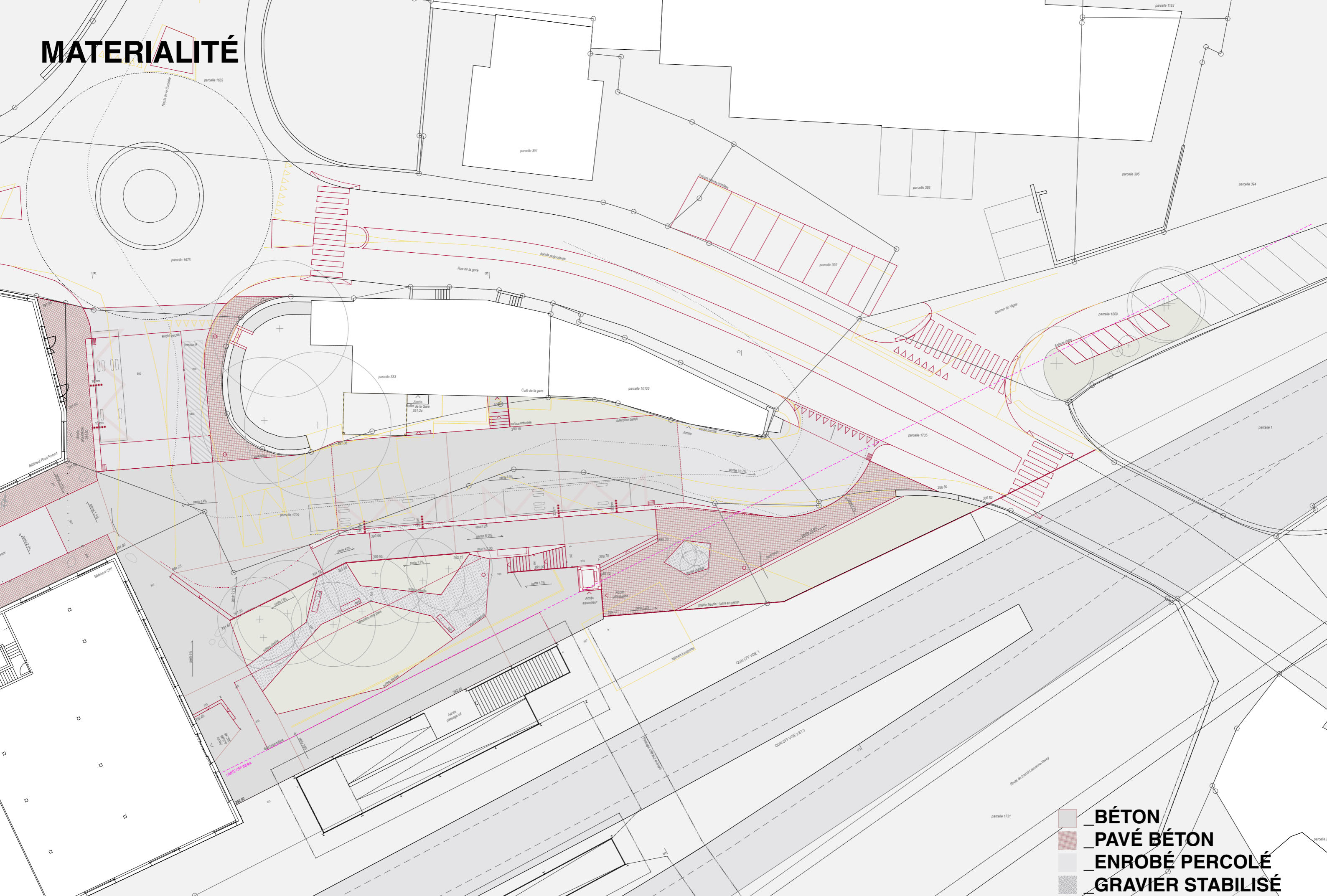

- BÉTON
- PAVÉ BÉTON
- ENROBÉ PERCOLÉ
- GRAVIER STABILISÉ



# MERCI